



# CAMPUS LIFE

Moving to a new place can be intimidating, but living where you study will help with your transition. Missouri State University-West Plains offers two residence halls: the Grizzly House and Grizzly Lofts. Our residence halls will help you build relationships while also providing comfortable places to study and relax.

## Student Activities

From Welcome Week and back-to-school picnics to homecoming activities and Grizzly Athletics games, there are plenty of opportunities for you to experience the exhilarating lifestyle of a college student.

## Student Rec Center

Students can play a pick-up game of basketball, volleyball or racquetball in this 10,000-square-foot multipurpose building. The \$2.2 million facility is next to the Grizzly House and a few blocks from Grizzly Lofts. The center also serves as an emergency storm shelter for the campus. In addition, it can be used to host a variety of student-related activities and events.

## Housing Policy

All single students under 21 years of age who have completed fewer than 27 hours of transferable credit after high school graduation and live farther than 100 miles from campus are required to live in university housing. All such students must have on file a completed Student Housing Contract and deposit or an approved Request for Exception to the University Housing Policy form before enrolling in classes at Missouri State-West Plains.

# HOUSING

The Student Housing Contract is for the entire academic year. Contracts for the 2021-2022 academic year are available. Contracts for the 2022-2023 academic year will be available Jan. 25, 2022. A complete Housing Contract includes a \$100 deposit and a meningitis vaccination record.

Apply for housing: [MyGrizzlyDen.MissouriState.edu](https://MyGrizzlyDen.MissouriState.edu)

Students will need to be admitted to the university before they are able to access the housing contract online.

Learn more: [WP.MissouriState.edu/HousingContract](https://WP.MissouriState.edu/HousingContract)

## Grizzly House Cost

For the 2021-2022 academic year (fall 2021 and spring 2022), the cost per semester is \$3,139, which includes utilities and 19 meals per week at the Putnam Student Center.



## Grizzly Lofts Cost

For the 2021-2022 academic year (fall 2021 and spring 2022), the cost per semester is \$3,475, which includes utilities and 19 meals per week with on-site dining.

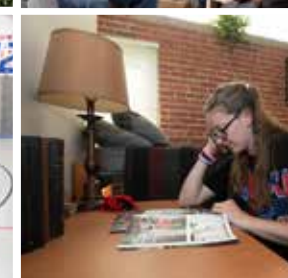
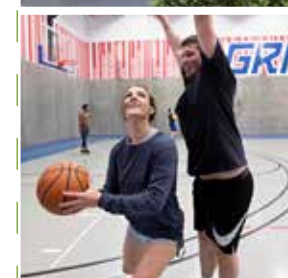

### FOR MORE INFORMATION, CONTACT:

Office of Residence Life  
128 Garfield Ave.  
West Plains, MO 65775  
[WP.MissouriState.edu/Housing](https://WP.MissouriState.edu/Housing)

417-256-1870 • [WPresHall@MissouriState.edu](mailto:WPresHall@MissouriState.edu)

All content provided in this publication is intended for informational purposes and is subject to change.

EO/AA/M/F/Veterans/Disability/Sexual Orientation/Gender Identity

# HOUSING

# 2021-2022

[WP.MissouriState.edu/Housing](https://WP.MissouriState.edu/Housing)



# GRIZZLY HOUSE

Experience all aspects of college life by living in the Grizzly House, a 60-person residence hall located in the heart of the Missouri State University-West Plains campus. The Grizzly House provides students with a friendly atmosphere in which to live. The Garnett Library, Hass-Darr Hall, classroom buildings and Putnam Student Center and cafeteria are within walking distance.



# GRIZZLY LOFTS

The Grizzly Lofts, Missouri State-West Plains' residential community, gives students living in university housing a whole different perspective of campus life. Located just a few blocks from campus in the renovated International Shoe Company building, the 274-person facility features on-site dining and is a great place to enjoy the total college living experience.

## GRIZZLY HOUSE

### ABOUT THE SUITES

- Four-person suites
- Full bathroom
- Living room with couch, chair and coffee table
- Refrigerator
- Desks and wardrobes
- Extra-long twin beds

### THE AMENITIES

- Community room complete with TV and DVD player
- Free internet
- Computer lab
- Lighted basketball courts
- Laundry facility

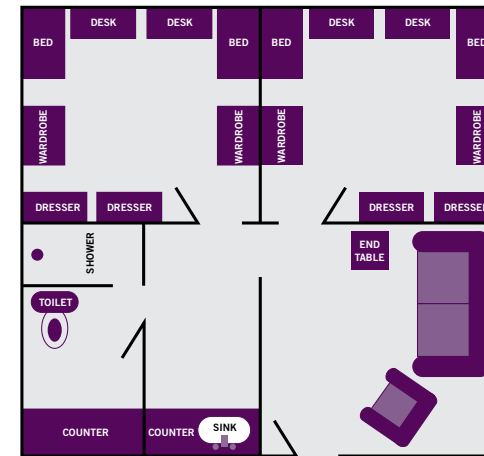

\*The objects in the diagram are not to actual scale.

- Close proximity to fitness center
- Adjacent to Student Rec Center
- Separate dining facility
- Security cameras and limited access entries

## GRIZZLY LOFTS

### ABOUT THE SUITES

- Four-person suites
- Full bathroom
- Desks and chairs
- Three-drawer bureaus
- Extra-long twin beds

### THE AMENITIES

- Private and group study rooms
- Free internet
- On-site dining
- Community room complete with TV, video games, ping pong, and a pool table

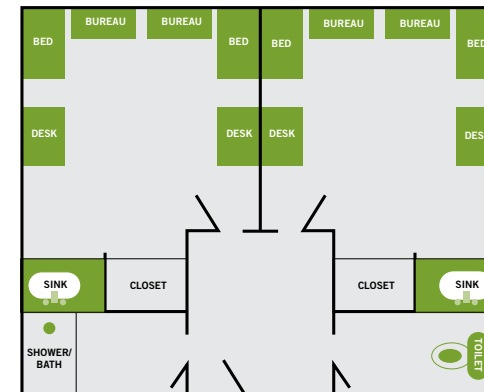

\*The objects in the diagram are not to actual scale.

- Fitness center
- Computer lab
- Laundry facility
- Sand volleyball court
- Adjacent to city walking park
- Security cameras and limited access entries